

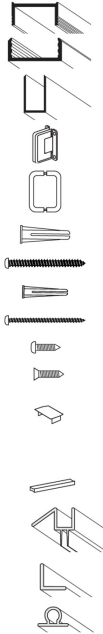

TRUFIT SHOWER DOOR INSTALLATION INSTRUCTIONS

PARTS LIST

ITEM PART	DESCRIPTION	QTY
A ZSS-4506	Wall Jamb	1
B ZSS-4505	Hinge Jamb	1
C ZSS 4504	Longer Piece = Wall Channel	1
D ZSS 4504	Shorter Piece = Curb Channel	1
E CHG HGTW*	Glass Hinge	2
F CHG BTB	Back-to-Back Pull	1
G CMF Anchor	Plastic Anchors for Wall Jamb	6
H #10 x 2"	Wall Jamb Screws	8
J ZV-935	Plastic Anchors for Channels	6
K #8 x 2"	Wall and Curb Channel Screws	6
L #8 x 3/4"	Hinge Jamb to Wall Jamb Screws	5
M #10 x 3/4"	Heavy Glass Hinge to Post Screws	8
N ZV 969	Adjustable Post Cap	1
O	3/8" Clear Glass Door	1
P	3/8" Clear Glass Panel	1
Q SP-GSB125	Glass Blocks	6
R CHGP982	Bottom Sweep	1
S CHGP976	Angle Seal (Optional)	1
T CHGP972	Bulb Seal (Optional)	1



IMPORTANT NOTE:

Door should not be used for 72 hours in order to let silicone cure properly.

*Standard hinge part number listed. Reference original order PO for replacement parts. Hinge styles may vary.

When ordering repair parts, please provide the following information:

1. Model Number
2. Part Number
3. Part Description
4. Finish Color

Required Tools:

- **TWO PEOPLE**
 - Pencil
 - Tape Measure
 - Electric Drill
 - Phillips Head Bit
 - Scissors
 - Level
 - Flat Head Screwdriver
 - Hammer
 - Silicone
 - Painters or Masking Tape
 - 1/8" and either 3/16" or 1/4" Drill Bits*
- * Select the proper drill bits for your installation conditions (i.e. tile, porcelain, marble, etc)

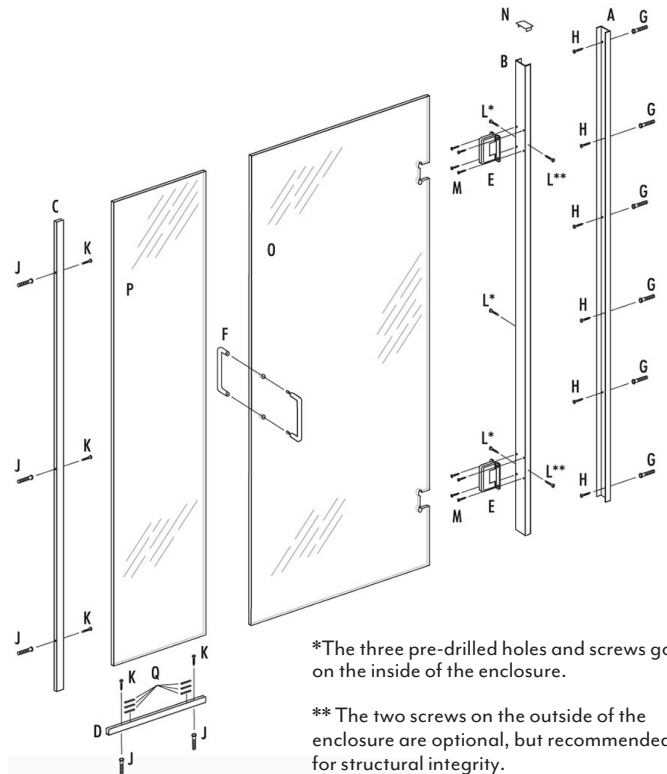

*The three pre-drilled holes and screws go on the inside of the enclosure.

** The two screws on the outside of the enclosure are optional, but recommended for structural integrity.





TRUFIT SHOWER DOOR INSTALLATION INSTRUCTIONS

GENERAL INFO:

- Please take a few minutes and thoroughly read the instructions before you start the installation.
- **YOU WILL NEED TWO PEOPLE** to install this unit
- If at any point in the installation, you have questions, please contact the dealer through whom you purchased this enclosure.
- **FAILURE TO FOLLOW THE INSTRUCTIONS COULD RESULT IN SERIOUS INJURY, DAMAGE OR DEATH.** Not to scare you, but you need to take this seriously.

BEFORE YOU START YOUR INSTALLATION:

- Purchaser is responsible for observing all local plumbing and building codes. Please consult your local building codes and compliance standards before installation to ensure conformity.
- We recommend that this enclosure be installed into secure wall studs on the door hinge side. However, it should work fine if installed into a solid substrate (such as sheet rock board or green board) with the appropriate wall anchors. A fiber-glass unit with nothing behind it is not suitable for mounting a TRU-FIT enclosure.
- Make sure your enclosure is the proper size for your opening.
- This enclosure is designed to handle minor out-of-plumb conditions and mildly uneven sill conditions. If either of your walls are more than 1/2" out-of-plumb, this unit is not suitable for your conditions.
- If the sill is not level, there could be some variances in the spacing between sill and door. It will be very **IMPORTANT** that you note these outages precisely and adjust the spacing of the glass off the sill accordingly so that the glass **CANNOT** hit the sill while in operation.
- Make sure you have all the proper tools. The installer is responsible for selecting the appropriate drill bits for the installation surface conditions.
- If you are installing on freshly laid tile, allow enough time for the tile cement and grout to fully dry before installing the shower enclosure.

DISCLAIMERS:

- Our Shower Enclosures is in no way responsible for any damage or bodily injury caused by an improper installation. Failure to follow these instructions, guidelines and warnings will void your warranty, and possibly cause anything from minor water damage to serious injury or death.
- These units have been tested under extreme usage conditions and have not failed **WHEN PROPERLY INSTALLED.**

WHEN YOU START YOUR INSTALLATION:

- Carefully remove all the enclosure parts and components from the packaging and keep the packaging until the installation is complete. Inventory all the parts and inspect them for damage. If any of the parts are damaged, please contact your local distributor.

AFTER INSTALLATION:

- For the first 72 hours after installation, do not operate the door or use the shower. This will allow time for the silicone to cure properly.
- Save this manual for future references.

ITEMS LISTED AS OPTIONAL:

- The two screws for the outside of the unit to secure the hinge jamb to the wall jamb are **HIGHLY RECOMMENDED** to reduce movement and provide a truly stable door.
- Three different polycarbonates are provided to help prevent water from escaping the shower. It is up to the installer/owner to determine if these are necessary.

CARE AND MAINTENANCE:

- Do not use harsh cleaners on your enclosure, as these can scratch or otherwise damage your enclosure.
- The shower enclosure can remain beautiful for years with the proper care. Some items, such as polycarbonates, may need to be replaced over time when they show signs of wear, are yellowing, or are not as functional in holding back water.
- Water conditions vary, and may necessitate extra cleaning of your enclosure.
- We recommend that you wipe down your shower enclosure with a cloth or squeegee after each use.

TROUBLESHOOTING:

- For troubleshooting various installation issues, see the end of these instructions.

CAUTION

The TRU-FIT Shower Enclosure utilizes tempered glass. Tempered glass is very strong, but extreme care should be taken to protect the edges and corners to avoid contact with hard surfaces during installation. Tempered glass shatters into small pieces when broken to safeguard against major injury. Always use proper PPE when handling any type of glass or metal.



STEP 1

Determine center line of your shower base by measuring the thickness of the base and use a pencil to mark the center. Draw this line the entire length of the base. (See Figure 1)

STEP 2

Take the Wall Jamb (A) and line the center of it (indicated by the line) up with the center line of tub base found in Step 1. The post should be sitting on the tub or shower base. (See Figure 2)

STEP 3

Make sure that the Wall Jamb (A) is level before marking for holes. (See Figure 3)

STEP 4

Once the Wall Jamb (A) is level, use a pencil to mark the holes for drilling. Depending on the support behind the wall, Plastic Anchors (E) may or may not be required. If you are unsure, if unsure, use the Plastic Anchors (E) to be safe. If using an anchor, use 1/4" drill bits to drill holes on the specified marks. If wooden support is present and no anchor is required, use 3/16" drill bits to drill holes on specified marks. (See Figure 4)

NOTE: You may need several drill bits when drilling through certain types of tile or marble. Keep your drill bit cool by spraying with water throughout the drilling process.

FIGURE 1

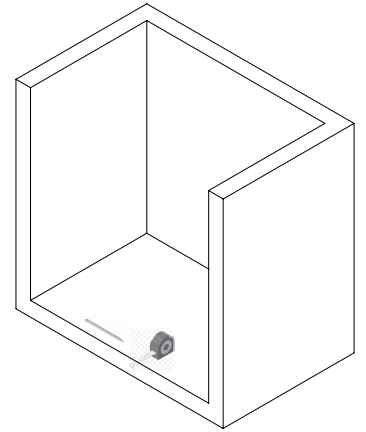

FIGURE 2

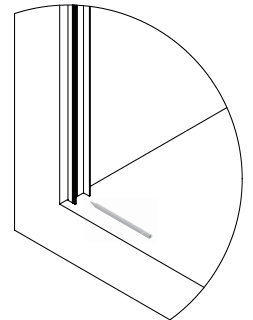

FIGURE 3

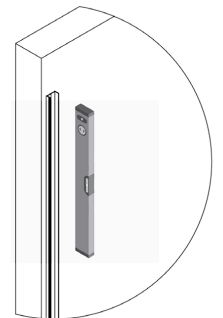
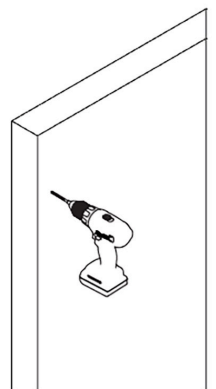

FIGURE 4



STEP 5

Put a small amount of silicone in each hole drilled. Place Plastic Anchors (E), if needed, in holes and gently tap with a hammer. Be sure not to hit the tile. (See Figure 5)

FIGURE 5

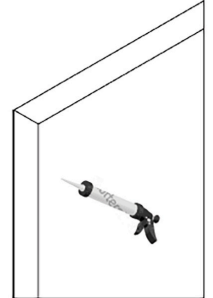

STEP 6

Set the Wall Jamb (A) in place and make sure holes line up. Using six #10 x 2" Wall Jamb Screws (F) provided, attach Wall Jamb (A) to wall. (See Figure 6)

NOTE: Two extra screws (F) are provided in case of installation issues.

FIGURE 6

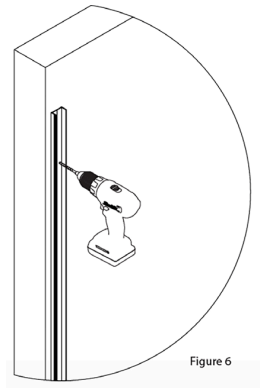

STEP 7

Now that you have the Wall Jamb (A) mounted, it is time to mount the panel Wall Channel (C) and Curb Channel (D). You should have two different length pieces of the channel (ZSS 4504), the shorter one is the bottom channel or Curb Channel (D), the longer is the Wall Channel (C). Take the Curb Channel (D) and place on your "centerline" of your base and make sure it is all the way against the wall. (See Figure 7)

Use your masking tape to secure the Curb Channel (D) to your base. **DO NOT USE SILICONE OR SCREWS YET, ONLY TAPE.** (See Figure 7)

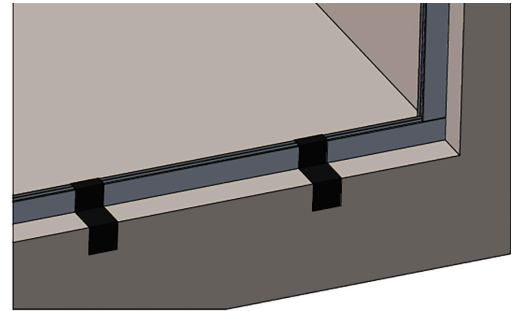
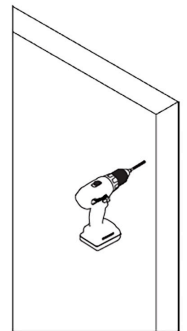

FIGURE 7

STEP 8

Place Wall Channel (C) on top of Curb Channel (D) and "centerline" up wall. Once the Wall Channel (C) is plumb, use a pencil to mark the holes for drilling. Depending on the support behind the wall, Plastic Anchors for Channels (J) may or may not be required. If you are unsure, use the Plastic Anchors for Channels (J) to be safe. If using an anchor, use 3/16" drill bits to drill holes on the specified marks. If wooden support is present and no anchor is required, use 1/8" drill bits to drill holes on specified marks (See Figure 8)

FIGURE 8



STEP 9

Put a small amount of silicone in each hole drilled. Place Plastic Anchors for Channels (J), if needed, in holes gently tap with hammer until anchor is flush. It might be necessary to use a razor knife to cut the lip of the anchor off so it is completely flush with the wall. Be sure not to hit the tile. (See Figure 9)

Set Wall Channel (C) in place and make sure holes line up. Using #8 x 2" Wall Channel Screws (K) provided, attach Wall Channel (C) to wall.

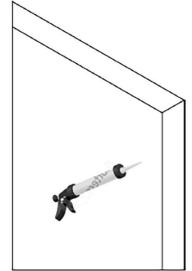

FIGURE 9

STEP 10

Once Wall Channel (C) is attached, remove tape from Curb Channel (D) and carefully slide directly out from under Wall Channel (C) (See Figure 10)

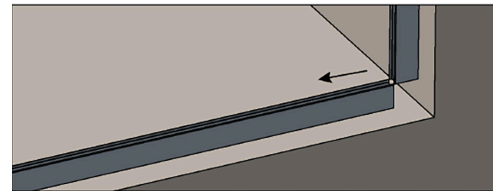

FIGURE 10

STEP 11

Place Glass Blocks (Q) on base to protect edge of glass panel while adjusting for size (See Figure 11B). Set Glass Panel (P) on blocks and gently slide into Wall Channel (C). Make sure panel is as far in to the Wall Channel (C) as possible. **THE PURPOSE OF THIS STEP IS FOR SPACING ONLY. PANEL WILL BE REMOVED AGAIN, SO DO NOT PERMANENTLY ATTACH.** Using several pieces of tape, inside and outside, secure Glass Panel (P) to wall for the time being. (See Figure 11A)

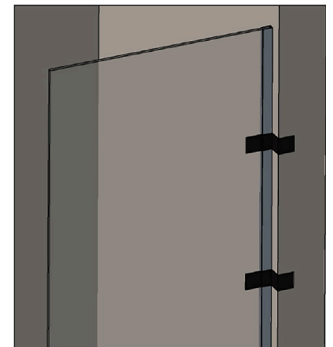

FIGURE 11A

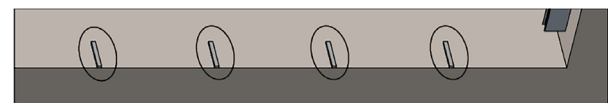
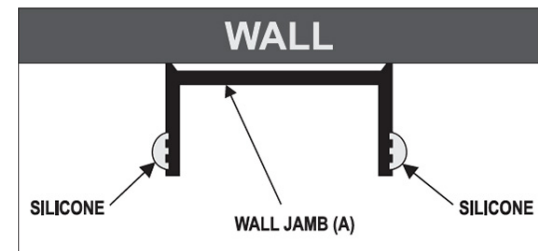

FIGURE 11B

STEP 12

With all six Wall Jamb Screws (H) securely in place, apply bead of silicone to the outside ribbed edge of Wall Jamb (A) running the entire length of both sides. (See Figure 12)



STEP 13

Set Wood Block on center of base for spacing and safety. Set the Glass Door (O) on top of Wood Block (U) and position Hinge Jamb (B) to go over the Wall Jamb (A). USING TWO PEOPLE (1 PERSON INSIDE, 1 PERSON OUTSIDE), slide Hinge Jamb (B) over Wall Jamb (A) carefully until fully compressed. (See Figure 13) Wood Block should still be under the Glass Door (O).

ONCE COMPLETED, DO NOT LEAVE DOOR UNATTENDED, IT COULD STILL FALL!

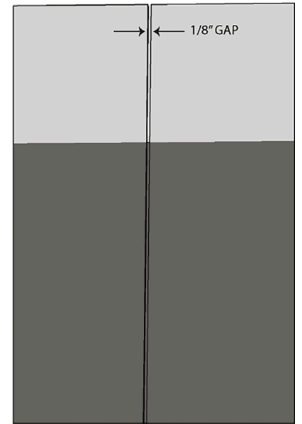

FIGURE 13

STEP 14

Note that the Glass Door (O) and Glass Panel (P) are setting in place, while one person steadies the door the other can adjust both pieces of glass so that you have about 1/8" gap between glass panels. (See Figure 14) (1/8" is recommended to reduce leakage, but can be larger if desired). It is ideal to adjust a little in both door and panel instead of pulling all the adjustment out of one or the other (depending on your size, you might have to fully adjust both to ensure proper fit). Make sure that the 1/8" gap is uniform the entire length of the door. Make sure the door is level before drilling holes. (See Figure 14)

ADJUSTMENTS

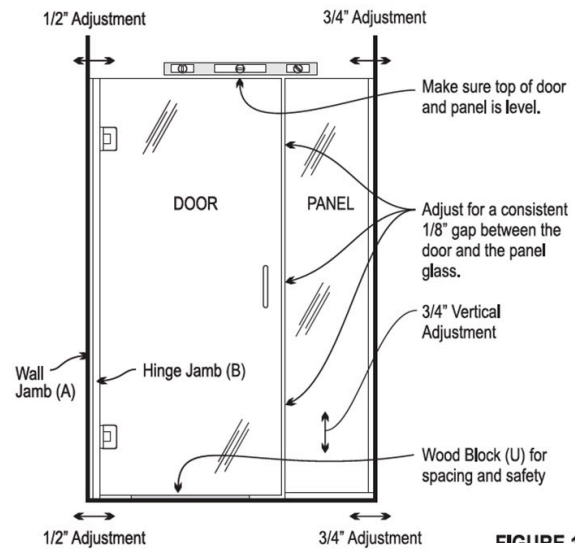
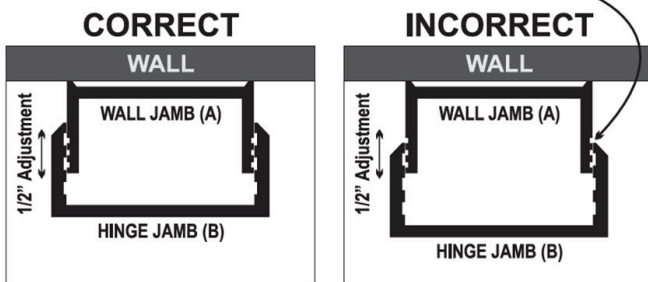

FIGURE 14

IT IS IMPORTANT TO MAKE SURE THAT HINGE JAMB (B) IS NOT PULLED SO FAR OFF WALL JAMB (A) THAT RIBBED AREA IS SHOWING.



STEP 15

Once adjusted, take a 1/8" drill bit and place in pre-drilled holes on Hinge Jamb (B). Drill three pilot holes through the Wall Jamb (A). (See Figure 15)

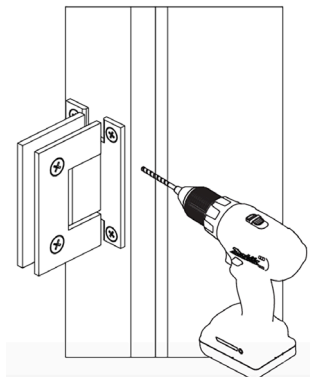

FIGURE 15

STEP 16

Install three #8 x 3/4" Self Tapping Screws (L) into the pilot holes drilled. (See Figure 16)

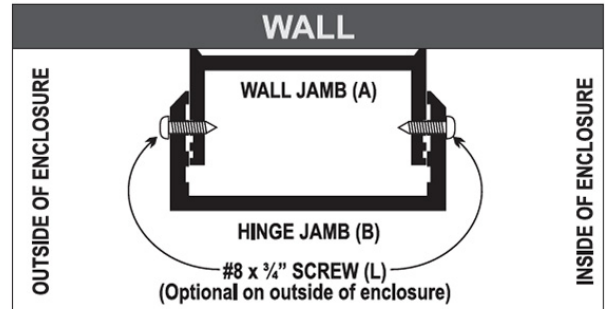

FIGURE 16

STEP 17

Now that the Glass Door (O) is secure, double check you have an 1/8" gap between door glass and panel glass. Make any necessary changes to the Glass Panel (P). (See Figure 17)

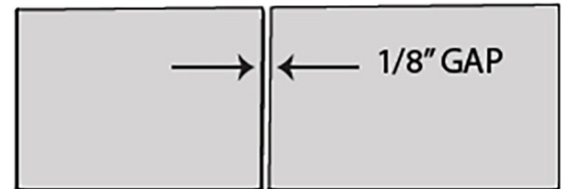

FIGURE 17

STEP 18

With the Glass Panel (P) in place, measure from wall to edge of panel glass. This measurement will be the length you need to cut your Curb Channel (D). (See Figure 18)

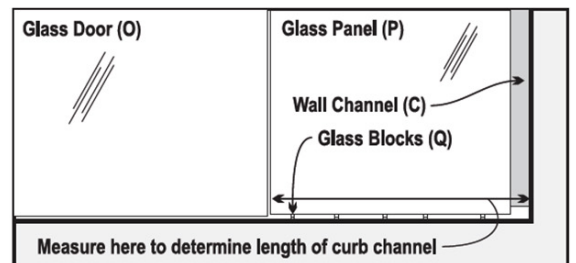

FIGURE 18

STEP 19

Using a pencil, mark your measurement on your Curb Channel (D). Proceed to cut the Curb Channel (D).

STEP 20

With door in the open position, carefully remove the Glass Panel (P) and Glass Blocks (Q) and drill pilot holes in curb channel as shown in Figure 20 A. Replace the Curb Channel (D) under the Wall Channel (C). Use a pencil to mark for pilot holes and remove channel for drilling. Using a 3/16" drill bit, drill two pilot holes through the Curb Channel (D) into base (See Figure 20A). Space both holes per Figure 20A. **PUT A DROP OF SILICONE** in holes, re-place Curb Channel (D) and secure with #8 x 2" Screws (K). (See Figure 20B)

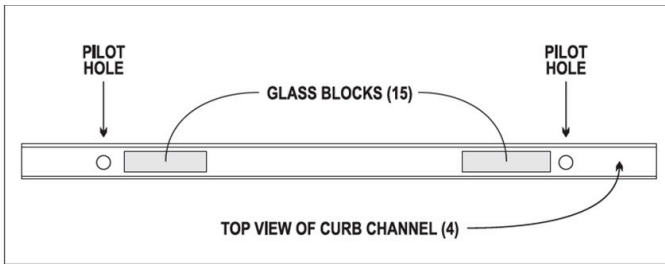

FIGURE 20A

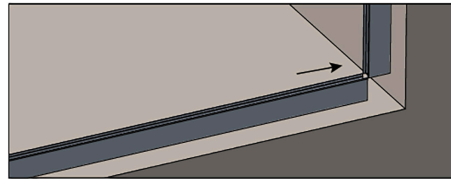

FIGURE 20B

STEP 21

Place two stacks of three Glass Blocks (Q) inside the Curb Channel (D) per Figure 20A. **NOTE: DO NOT SET ON SCREW HEADS.** These glass blocks will be used not only to cushion and protect panel from screw heads but to also adjust the height of the panel to match the door. You can remove glass blocks to lower panel, cut glass blocks in half and stack more than three to raise the panel. (See Figure 21A). When ready to install glass, put four or five globs of silicone on the inside of the wall channel (See figure 21B). Set Glass Panel (P) in the Curb Channel (D) on Glass Blocks (Q) and gently push into Wall Channel (C) until glass is event Curb Channel (D).

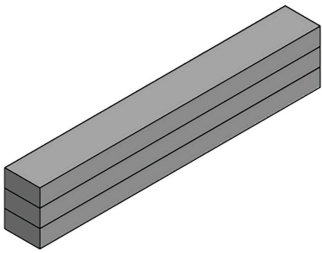

FIGURE 21A

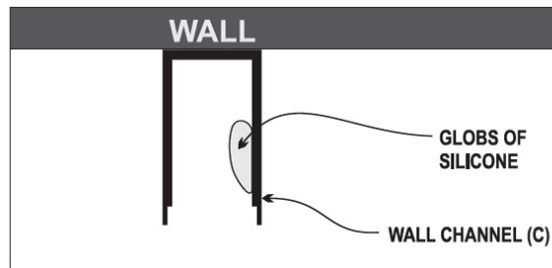

FIGURE 21B

STEP 22

Double-check that the height of the Glass Panel (P) is even with the Glass Door (O) and 1/8" gap between pieces of glass is uniform. (See Figure 22)

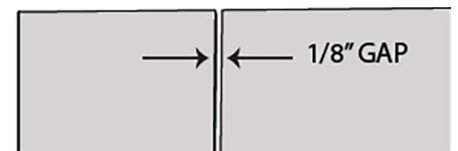

FIGURE 22

STEP 23

Silicone the Glass Panel (P) in place by applying an even bead inside troughs on both sides of Wall Channel (C) and Curb Channel (D) as well as where the wall channel and curb channel meet the wall and base. (See Figure 23)

Clean off any excess silicone.

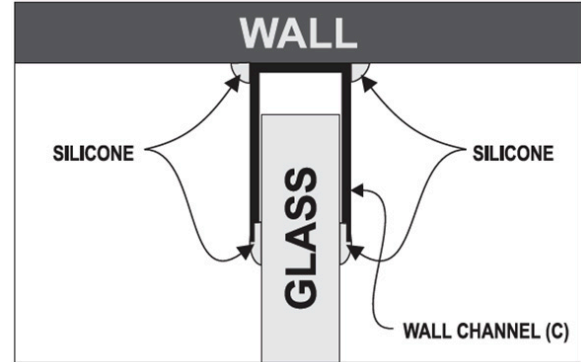

FIGURE 23

STEP 24

We have supplied two extra #8 x 3/4" SelfTapping Screws (L).

WE RECOMMEND PUTTING THESE ON THE OUTSIDE OF THE UNIT FOR EXTRA SUPPORT.

These are not necessary, but highly suggested to eliminate any movement during usage. Using a 1/8" drill bit, drill two pilot holes through both the Hinge Jamb (B) and the Wall Jamb (A) centered vertically with the Door Hinges (E). (See Figure 24)

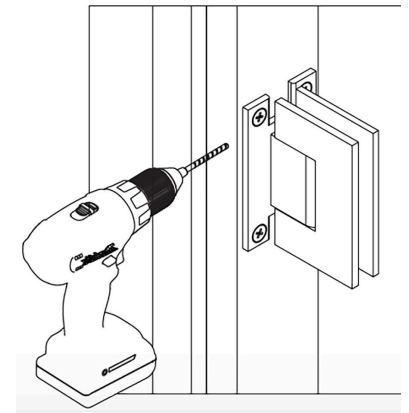

FIGURE 24

STEP 25

Apply a bead of silicone where the Wall Jamb (A) meets the wall on **BOTH** sides. (See Figure 25)

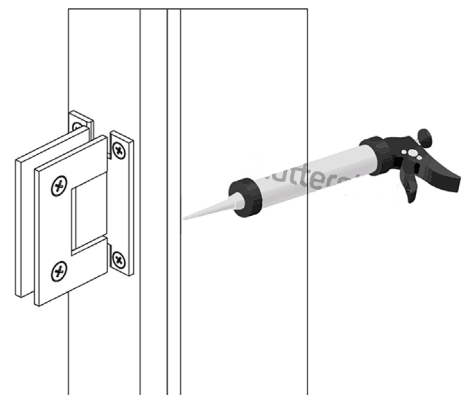

FIGURE 25

STEP 26

The Adjustable Post Cap (N) covers the exposed top of the Wall Jamb (A) and Hinge Jamb (B). Set the cap in place BACKWARDS (only to mark it for cutting) with the legs going in Hinge Jamb (B) (See Figure 26A) and mark for cutting (See Figure 26B).

MAKE SURE CAP IS TOUCHING BACKWALL BEFORE MARKING.

Cut cap on mark using scissors. (See Figure 26C)

Place drop of silicone on the outside of both legs. (See Figure 26D)

Turn the Adjustable Post Cap (N) around and install with the legs going into the Wall Jamb (A). (See Figure 26E)

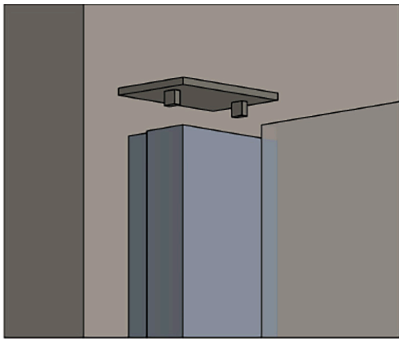

FIGURE 26A

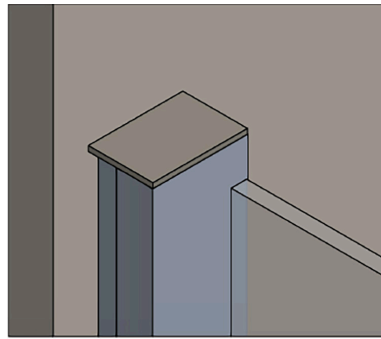

FIGURE 26B

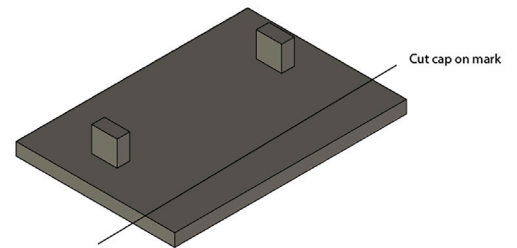

FIGURE 26C

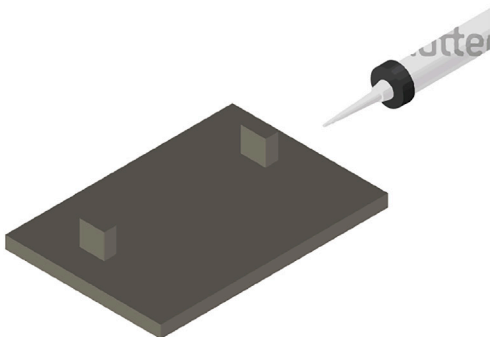

FIGURE 26D

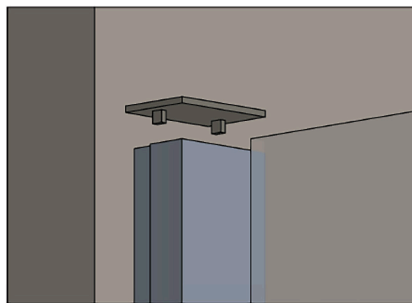

FIGURE 26E

STEP 27

To attach the Back-to-Back C-Pull (F), first loosen set screws with an allen wrench and take the pull apart. (See Figure 27)

NOTE: The pull is mounted so that there is no metal touching the glass. The clear plastic washers go on either side of the glass between the pull and the glass.



FIGURE 27

STEP 28

Place handle through holes in the Door Glass (O). Make sure that the clear washers are touching the glass. Gently tighten handle screws so that handle is snug on glass. **DO NOT OVER-TIGHTEN THE SCREWS** with the allen wrenches supplied with the pull. Over-tightening can crack the washers. (See Figure 28A)

Place other side of handle on studs (See Figure 28B) with set screws facing down and tighten using allen key provided. (See Figure 28C and 28D)

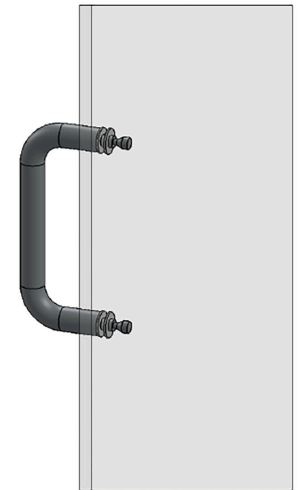

FIGURE 28A

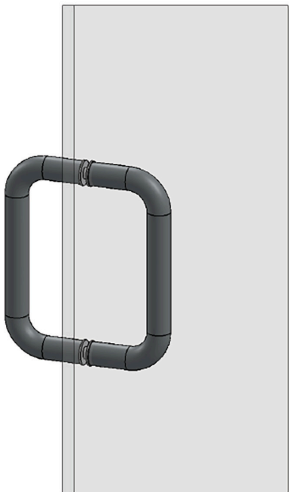

FIGURE 28B



FIGURE 28C

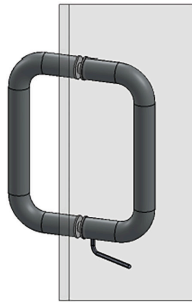

FIGURE 28D

STEP 29

There are three different polycarbonates provided. All are OPTIONAL and serve to help prevent water from escaping shower.

NOTE: If using the optional polycarbonates, for the best adhesion, clean glass or tile with alcohol before application.



ZV 952 Bottom Sweep (L) - This is attached by pressing it on bottom of door while door is open. Wood block should have been removed. (See Figure 29A)



ZV SDTB Bulb Seal (N) - This is to be placed on hinge edges of glass. You will need to cut into 3 pieces that will fit the small areas from top hinge to top of door, bottom hinge to bottom of door and the large area between hinges. Remove red covering to expose adhesive and apply to edge of glass. (See Figure 29B)



ZV Angle Seal (M) - This is to be placed on handle side of door, DIRECTLY to the Panel Glass (P) (make sure glass is clean and dry before application). (See Figure 29C)

CAUTION: By using this angle seal, your door will no longer be able to swing both in and out. (See Figure 29C)

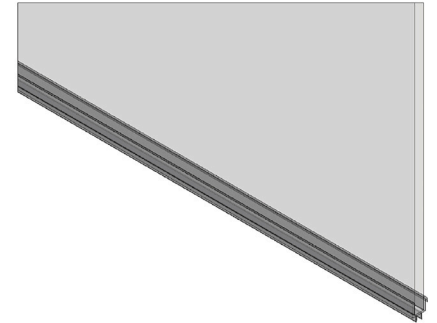

FIGURE 29A

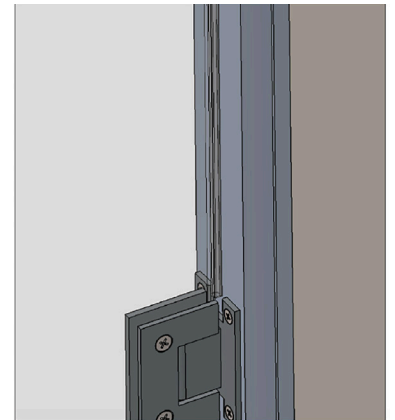

FIGURE 29B

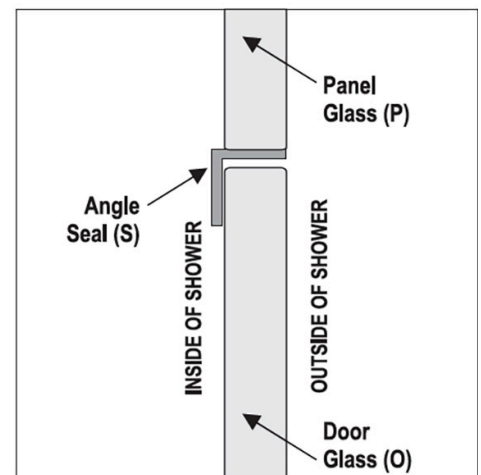

FIGURE 29C



TRUFIT SHOWER DOOR INSTALLATION INSTRUCTIONS

TROUBLESHOOTING

INSTALLATION:

If, while preparing to attach the Hinge Jamb (B) to the Wall Jamb (A), you are unable to get a consistent 1/8" gap between the Door Glass (O) and Panel Glass (P) without revealing the groove lines on the Wall Jamb (A), either your walls may be seriously out of plumb or your selected unit might not be the right size for your conditions. Double check your wall conditions and measurements.

OPERATION:

If you have not installed the #8 x 3/4" Set Screws (L) on the outside of the enclosure securing the Hinge Jamb (B) to the Wall Jamb (A), and you are noticing movement of the Hinge Jamb (B) during normal operation, we strongly suggest you go to Step 24 and install the Set Screws (L) on the outside of the enclosure.

WARRANTY CLAIMS

To make a claim under the provisions of this warranty, please contact your local sales rep. They should be able to solve any problem you might have.

If you are unable to obtain warranty service through your local sales rep, you can contact us at:

Mshower
203 N. Lewis Street
Lagrange, GA 30241
info@mgrouppcorp.com

Please include all relevant information regarding your claim:

- The model which was installed.
- The name and address of the installer..
- The installation address.
- A complete description of the problem.
- A photocopy of your invoice/receipts for the product installed.

Under no circumstances should Mshower products be returned to your dealer or distributor without a written Return Merchandise Authorization (RMA).

